



**GENERAL NOTES:**

1. FEATURES LOCATED PER "CHELAN RIVERFRONT SURVEY" BY JOHN REPASS & CO., 1984.
2. RIGHTS OF WAY AROUND NORTHEAST BRIDGE APPROACH LOCATED PER "CHELAN RIVERFRONT SURVEY" BY JOHN REPASS & CO., 1984.
3. RIGHTS OF WAY AROUND SOUTHWEST BRIDGE APPROACH LOCATED PER 1962 WASHINGTON STATE HIGHWAY COMMISSION DEPARTMENT OF HIGHWAYS "PRIMARY STATE HIGHWAY NO.10 CHELAN - PARK STREET TO CHELAN RIVER" DRAWINGS WHICH WERE TIED IN TO THE JOHN REPASS & CO. SURVEY.

**BRIDGE NOTES:**

- EXISTING BRIDGE:
- 10' LANES
  - 4" WALKS (INC. CURB)
  - 1 1/2" THICK CONC. RAILS
  - 31" OVERALL WIDTH
  - 28' WIDTH BETWEEN RAILS
- LAYOUT D REBAR WIDTH:
- 12' LANES
  - 4" CLEAR TO CURB
  - 10" WALK, ONE SIDE
  - 12" WIDTH BETWEEN RAILS
  - 32" BETWEEN CURBS (DECK CENTERED ON EXISTING SUBSTRUCTURE)

**WSDOT CRITERIA**

- (MODIFIED DESIGN LEVEL, FIG. 430-4)
- MIN. WIDTH BETWEEN CURBS = 32'
  - MIN. TRAVEL LANE WIDTH = 11'
  - MIN. SHOULDER WIDTH = 4'

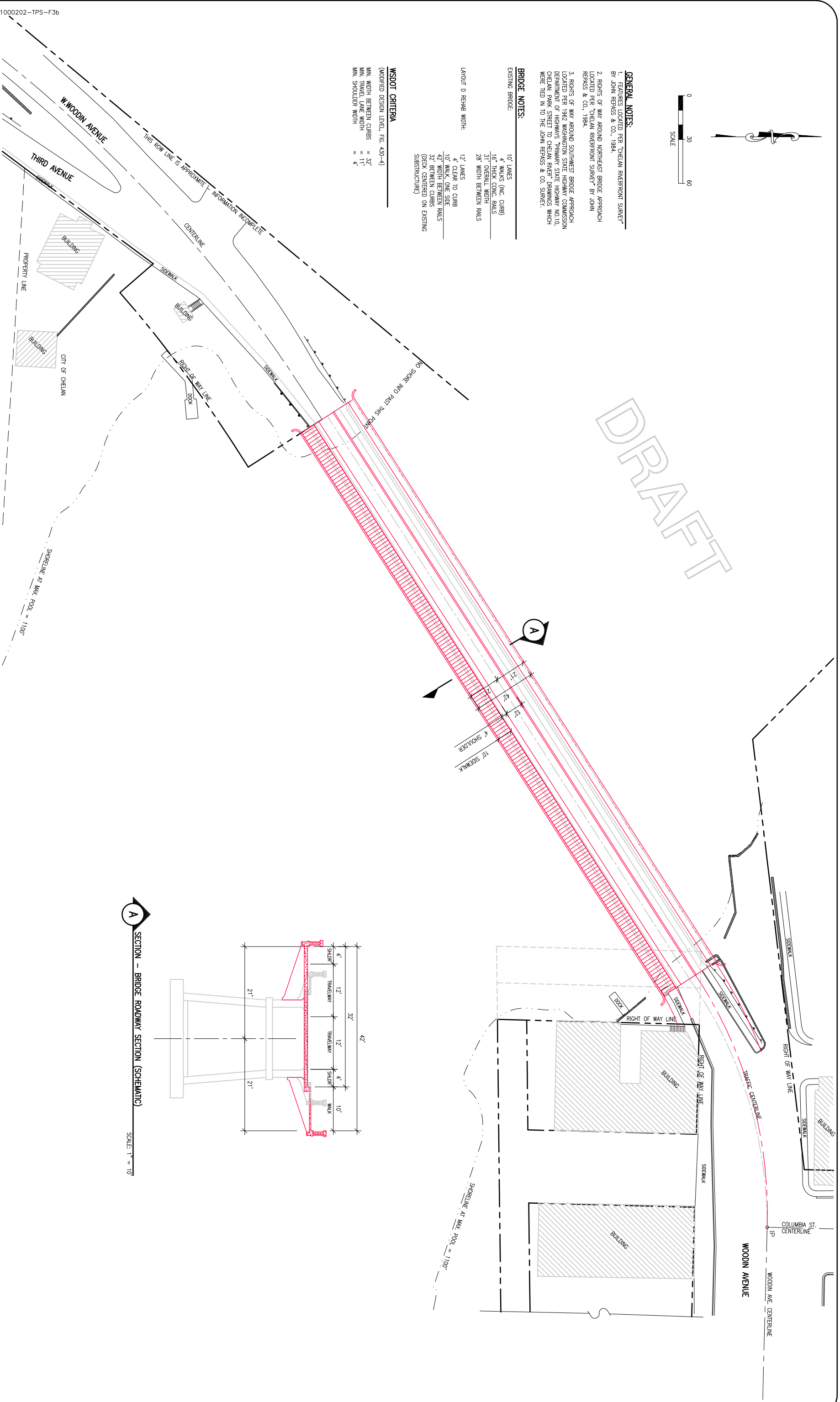

**A** SECTION - BRIDGE ROADWAY SECTION (SCHEMATIC)  
SCALE: 1" = 10'

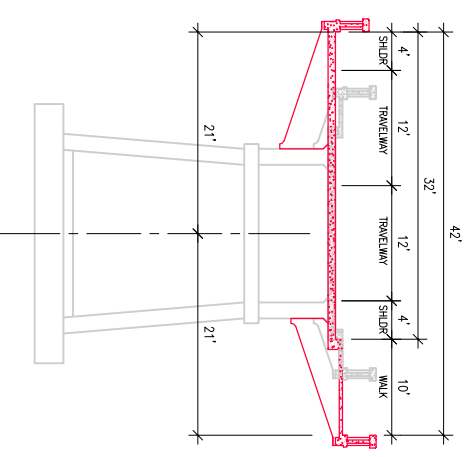

NO.	DATE	BY	CHKD.	APP.	REVISIONS

SCALE: AS-SHOWN  
 DESIGN: JSM  
 DRAWN: JSM  
 CHECKED: JSM  
 APPROVED: 100-02-02  
 PROJ. NO.: 04/23/03  
 DATE:



CITY OF CHELAN, WASHINGTON  
 WOODIN AVE. BRIDGE TRAFFIC AND PEDESTRIAN STUDY  
 PRELIMINARY LAYOUT D  
 12' LANES, 4' SHOULDERS, 10' WALK ON ONE SIDE  
 (DECK CENTERED ON EXISTING SUBSTRUCTURE)