

**GENERAL NOTES:**

1. FEATURES LOCATED PER "CHELAN RIVERFRONT SURVEY" BY JOHN REPASS & CO., 1984.
2. RIGHTS OF WAY AROUND NORTHEAST BRIDGE APPROACH LOCATED PER "CHELAN RIVERFRONT SURVEY" BY JOHN REPASS & CO., 1984.
3. RIGHTS OF WAY AROUND SOUTHWEST BRIDGE APPROACH LOCATED PER 1962 WASHINGTON STATE HIGHWAY COMMISSION DEPARTMENT OF HIGHWAYS "PRIMARY STATE HIGHWAY NO. 10 CHELAN - PARK STREET TO CHELAN RIVER" DRAWINGS WHICH WERE TIED IN TO THE JOHN REPASS & CO. SURVEY.

**BRIDGE NOTES:**

- EXISTING BRIDGE:
- 10' LANES
  - 4' WALKS (INC. CURB)
  - 1.6" THICK CONC. RAILS
  - 31" OVERALL WIDTH
  - 28' WIDTH BETWEEN RAILS

LAYOUT A REHAB WIDTH: 11' LANES  
(VARIANCE REQUIRED) 2' CLEAR TO CURB

- 5' WALKS
- 36" WIDTH BETWEEN RAILS
- 26' WIDTH BETWEEN CURBS

**WSDOT CRITERIA**

- (MODIFIED DESIGN LEVEL, FIG. 439-4)
- MIN. WIDTH BETWEEN CURBS = 32'
  - MIN. TRAVEL LANE WIDTH = 11'
  - MIN. SHOULDER WIDTH = 4'

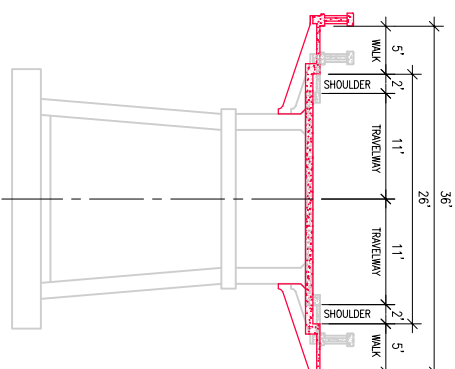
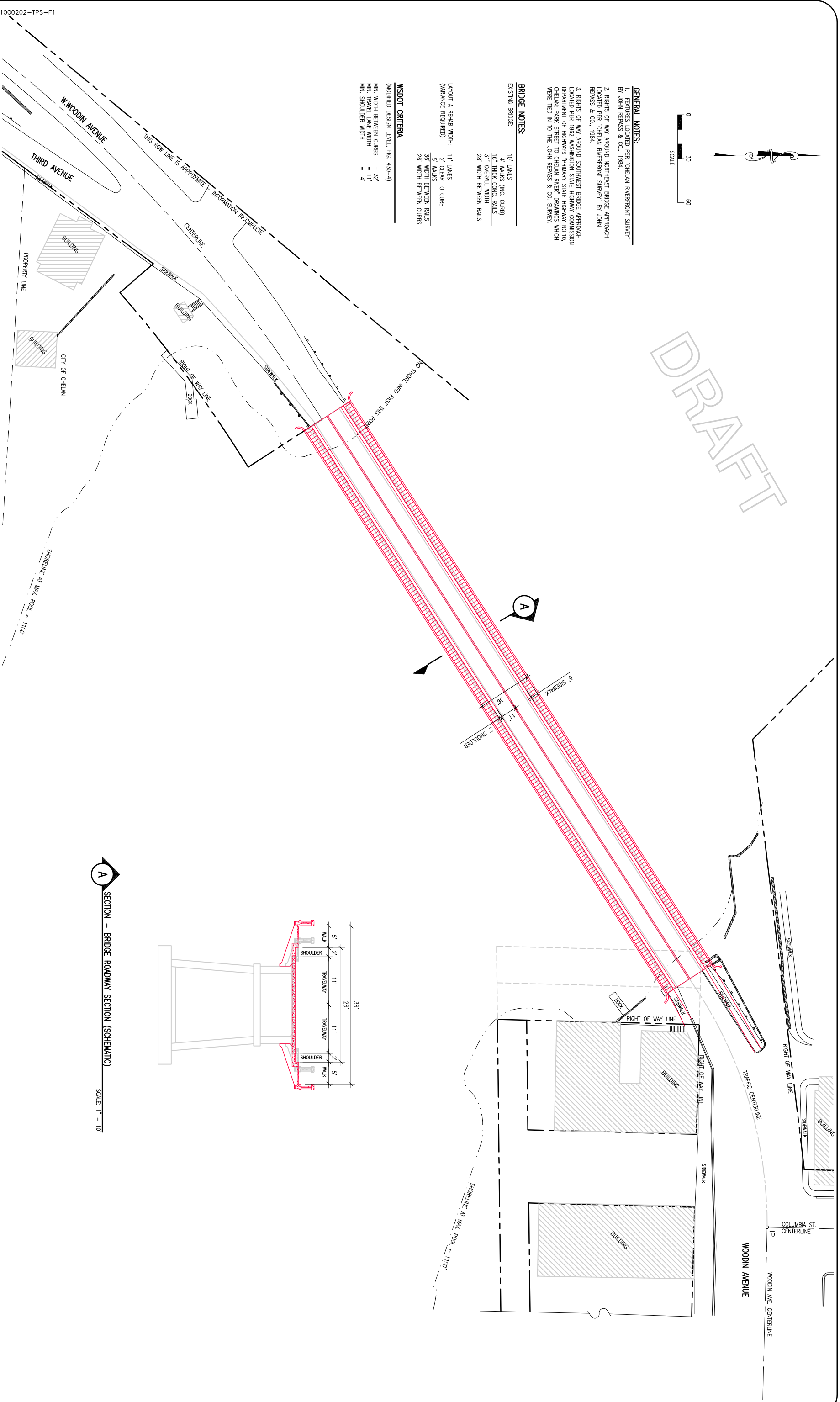

**A** SECTION - BRIDGE ROADWAY SECTION (SCHEMATIC) SCALE: 1" = 10'

NO.	DATE	BY	CHKD.	APP.	REVISIONS

SCALE: AS-SHOWN  
 DESIGN: JSM  
 DRAWN: JSM  
 CHECKED: JSM  
 APPROVED: 100-02-02  
 PROJ. NO.: 04/23/03  
 DATE:



CITY OF CHELAN, WASHINGTON  
 WOODIN AVE. BRIDGE TRAFFIC AND PEDESTRIAN STUDY  
 PRELIMINARY LAYOUT A  
 11' LANES, VARIANCE FOR 2' SHOULDERS, 5' WALKS  
 (CENTERED ON EXISTING SUBSTRUCTURE)

**FIGURE 1**